

HM-150FTC3 规格书 (FeedThrough Filter 馈通滤波器)

1. Outline Drawing and Dimensions:(mm)

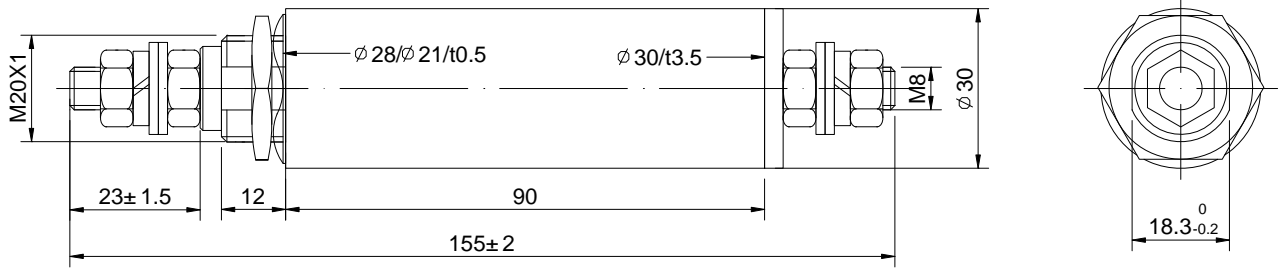

2. Specification:

Rated Voltage: 250VAC

Rated Current: 150A

Operating frequency: 50/60Hz

Leakage Current: (250V/50Hz) $\leq 4\text{mA}$

Test Voltage(2S): 2250VDC

Temperature Range: - 40°C ~ + 85°C

3. Circuit Diagram:

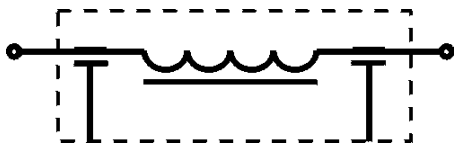

$C=2 \times 0.047 \mu F \pm 20\% (X2)$

4. Insertion Loss in dB: (Measured in 50Ω system)

